



Barry Lawrence Ruderman Antique Maps Inc.

7407 La Jolla Boulevard
La Jolla, CA 92037

www.raremaps.com

(858) 551-8500
blr@raremaps.com

[Section of Newport Beach]

Stock#: 33577df
Map Maker: Pacific Electric Railway
Date: 1913
Place: Los Angeles
Color: Pen & Ink
Condition: VG+
Size: 15 x 10 inches
Price: \$ 225.00

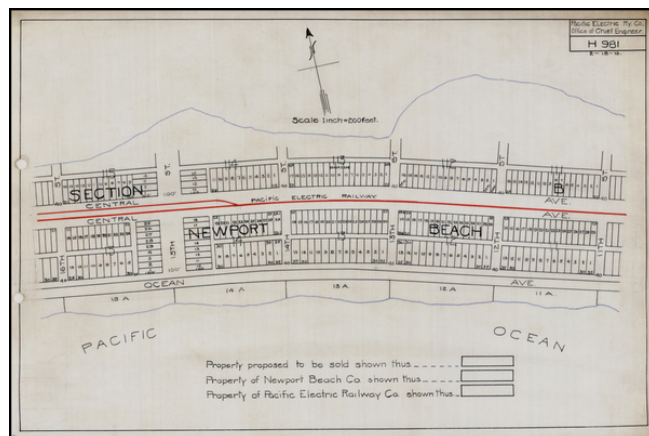

Description:

Detailed map of part of Newport Beach, showing the route of the Pacific Electric Railway from 11th Street to 16th Street, along Ocean Avenue and Central Avenue, showing the water lines on both the Newport Bay and Pacific Ocean sides of the peninsula, the property of the Newport Beach Company and Property of the Pacific Electric Railway Co.

Detailed Condition:

Two binding holes, from the original notebook.