



# Barry Lawrence Ruderman Antique Maps Inc.

7407 La Jolla Boulevard  
La Jolla, CA 92037

www.raremaps.com

(858) 551-8500  
blr@raremaps.com

## Map of Western - Melrose Business Place to be known as Tract No. 3783 when recorded

...

**Stock#:** 30070  
**Map Maker:** Engineering Service Company  
**Date:** 1920 circa  
**Place:** Los Angeles  
**Color:** Uncolored  
**Condition:** VG  
**Size:** 17 x 22 inches  
**Price:** SOLD

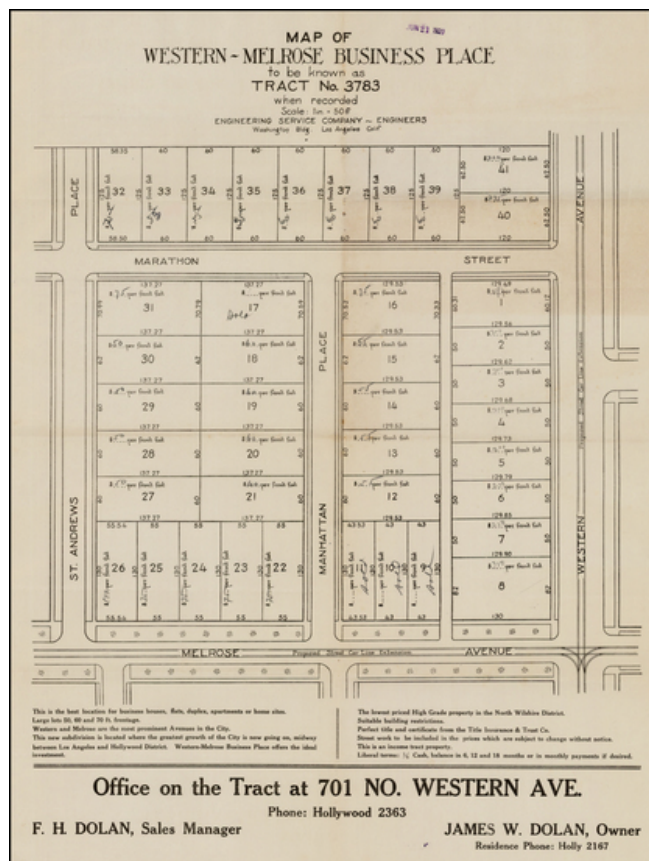

### Description:

Detailed Tract map of the land bounded by Marathon in the North, Melrose Avenue in the South, St. Andrews to the West and Western Blvd to the east, showing the the Western - Melrose Business Place.

The map was apparently owned by Walter McKee, a Los Angeles Real Estate figure, who has noted the cost of each lot on a square foot basis and the lot sales on the map.

The map discusses the benefits of ownership in the area, financing terms and other details. James W. Dolan is listed as the Owner, with F. H. Dolan the Sales Manager.

### Detailed Condition:

Drawer Ref:

Stock#: 30070



**Barry Lawrence Ruderman  
Antique Maps Inc.**

7407 La Jolla Boulevard  
La Jolla, CA 92037

[www.raremaps.com](http://www.raremaps.com)

(858) 551-8500  
[blr@raremaps.com](mailto:blr@raremaps.com)

---

**Map of Western - Melrose Business Place to be known as Tract No. 3783 when recorded**

...

Includes pencil annotations